

INFO SHEET

SHELVING SYSTEMS

POPULAR CONFIGURATIONS

FLEXIBLE SHELVING

In an environment created to facilitate the education and development of faculty, staff, students, and residents, flexibility is key. Flexibility to meet, flexibility to study, flexibility to create, and flexibility to collaborate.

Spacesaver's Flexible Shelving solution enables valuable available space to be used for multiple purposes. Providing users the ability to utilize their limited physical space as they see fit, this durable and versatile option can be moved and configured to accommodate the current need and easily adjusted for the next.

Below are our most popular configurations based on information provided by today's users - however, with our team of experts in design and manufacturing anything is possible. Contact your local Spacesaver representative to learn more about available sizes and custom options.



CANTILEVER FLEXIBLE SHELVING

STYLE A:

Library Storage

- 36" L x 24" D x 42" H
- (3) Adjustable shelves per side
- (1) Book support per shelf (centered)
- Concealed casters (non-locking)

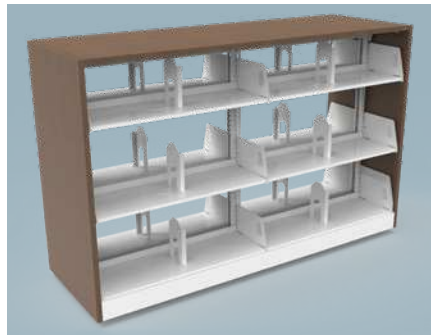

CANTILEVER FLEXIBLE SHELVING

STYLE B:

Library Storage

- 72" L x 24" D x 42" H
- (6) Adjustable shelves per side
- (1) Book support per shelf (centered)
- Concealed casters (non-locking)



CANTILEVER FLEXIBLE SHELVING

STYLE C:

Library Storage

- 36" L x 24" D x 42" H
- (3) Shelves per side
- (1) Divider (centered) per shelf
- Exposed casters (locking)



CANTILEVER FLEXIBLE SHELVING

STYLE D:

Library Storage

- 72" L x 24" D x 42" H
- (6) Adjustable shelves per side
- (1) Book support per shelf (centered)
- Exposed casters (locking)



4-POST FLEXIBLE SHELVING

STYLE E:

Multipurpose Storage

- 36" L x 24" D x 40" H
- (4) Universal shelves
- (1) Back panel
- Exposed casters (locking)



4-POST FLEXIBLE SHELVING

STYLE F:

Multipurpose Storage

- 72" L x 24" D x 40" H
- (4) Plain shelves
- (1) Back panel
- Exposed casters (locking)





4-POST FLEXIBLE SHELVING

STYLE G:
Athletic, Fine Arts, and Classroom Storage

- 72”L x 24”D x 40”H
- (4) Universal shelves
- (3) Bin dividers per shelf
- (1) Back panel
- Exposed casters (locking)



4-POST FLEXIBLE SHELVING

STYLE H:
Art Storage

- 72”L x 24”D x 40”H
- (2) Universal shelves
- (5) Bin dividers
- (1) Back panel
- Exposed casters (locking)



4-POST FLEXIBLE SHELVING

STYLE I:
Supplies, Equipment, and Makerspace Storage

- 36”L x 24”D x 40”H
- Assorted storage bins (available in many sizes)
- EZ Rails – (1) sloped and (1) straight for hanging bins
- (3) Plain shelves
- (1) Back panel
- Exposed casters (locking)

NOTE: Flexible Shelving dimensions are approximate and do not include expanded footprint due to panel finishes or caster base height. The panels shown above are an example of a laminate finish (also commonly available in wood, acrylic, and resin) sourced directly through our network of local Spacesaver distributors.

TOP-DOWN VERSATILITY

Spacesaver is different from other shelving providers. We offer local consulting and design expertise – every step of the way, from planning to installation and beyond – ensuring our solutions provide the aesthetics, fit, and function your space requires.

Contact us to arrange a free on-site consultation to assess your space, offer insights, and help design a safe, effective system for your staff, students, and patrons.

Serving Oregon and SW Washington



Your library specialist - Kelly Pendergrass
503.612.2605 - kelly@storageplanning.com

Spacesaver Specialists, Inc.
9730 SW Herman Road | Tualatin, OR 97062
www.storageplanning.com



Spacesaver Corporation
1450 Janesville Avenue
Fort Atkinson, WI 53538-2798
800.492.3434
www.spacesaver.com